

Napier Central School



Pepeha - Our Story

Ko Mataruahou te maunga.

Mataruahou is the mountain.

Ko Te Moana nui a Kiwa te moana.

The Pacific Ocean is the ocean.

Ko Tūtaekurī te awa.

Tūtaekurī is the river

NAPIER CENTRAL SCHOOL

Ko Tākitimu to waka.

Tākitimu is the canoe.

Ko Ngāti Kahungunu te iwi.

Ngāti Kahungunu is the tribe.

Kei Te Matau a Māui ahau e noho ana.

Hawke's Bay is our home.

Ko Napier Central tō mātou kura.

Napier Central is our school.

Takoto pai tāu tūranga.

Lay Well Thy Foundation.

2024

Parent Information Booklet

Empowering Active Learners



SCAN ME

LAY WELL THY FOUNDATION GROWING ACTIVE & EMPOWERED LEARNERS



Welcome To Our School

We are delighted to have your child join us, either as a New Entrant or as a new pupil in a higher class. We aim to give your child the best possible start to their school life. If you are still considering the choice of school for the education of your child, please feel welcome to contact us if you have any further questions. Our website: www.napiercentral.school.nz has a wealth of information of the school in action.

Napier Central has experienced and talented staff. We deliver the New Zealand curriculum thoroughly with a particular emphasis upon the core subjects of reading, written language and mathematics. Learning to think, create and collaborate are vital skills for the future. We nurture resilience and open mind set in every child. We pride ourselves also on a high level of sporting and cultural expertise including interschool competitions, choir and orchestra and biennial musical productions.

We endeavour to work closely with parents to ensure a strong home-school partnership. Two-way communication supports your child's development and progress. Parents presence in the school and their contribution to school life and their child's education is a fundamental aspect of school life.

We look forward to working with all prospective parents and trust that your association with our school, staff and Board of Trustees members, is a positive and worthwhile experience for your family.

Ross McLeod
Principal



Best
possible
start!

Contents

• Welcome from our Principal	Page 2	• Dental clinic	Page 15
• Contents	Page 3	• Road patrol & parking	Page 15
• NCS Vision & Values	Page 4	• Parent Assistance	Page 15
• Enrolment zone	Page 4	• School Stationery	Page 16
• Contact details & Map	Page 5	• Lunch Online	Page 16
• Our staff	Page 6	• School banking	Page 16
• BOT	Page 7	• Lost property	Page 17
• School Donation	Page 7	• Swimming pool	Page 17
• Enrolment checklist	Page 8	• Concerns & complaints	Page 17
• New Entrant meetings	Page 8	• Staying informed	Page 18
• Future focused education	Page 9/10	• Using the school App	Page 19
• Enviro-schools Programme	Page 11	• Absences and illness	Page 20
• Garden to Table	Page 11	• School Uniform	Page 21
• Culture and the Arts	Page 12	• Sports	Page 22
• School hours & Term dates	Page 13	• Camp	Page 23
• Emergency procedures	Page 14	• PTA	Page 24
• Severe allergy awareness	Page 14	• HASCAP - after school care	Page 25
• Class trips	Page 14	• Reporting to Parents	Page 26
		• Frequently Asked Questions	Page 27



Napier Central School

Napier Central is one of New Zealand's oldest schools and boast a proud tradition of giving our children the best possible start. The foundation we set for your child's future is firmly grounded on a broad educational foundation.

Our Vision

"Lay Well Thy Foundation"

Mission Statement

"Developing Active and Empowered Learners"

Our Values

Our school values are encouraged, lived, and regularly reviewed by everyone in our school. The values are represented by the word RIPE:

Respect - Manaakitanga

Integrity – Ngākaupono

Perseverance - Manawanui

Empathy - Aroha

Enrolment Zone

Napier Central School has enrolment zone to manage entry. "As of right" entry is given to those residing in the zoned area as directed by the Ministry of Education.

Out of zone enrolment applicants should email the school office or write a letter requesting a place at our school. If the number of out of zone applications exceeds the number of places available, placements will be selected by ballot.

The zone commences at the corner of Marine Parade and Emerson Street proceed north along Marine Parade and around the Napier Port, Breakwater Road. Turn south into Ahuriri Bypass. Turn southeast at Shakespeare Road intersection, along Shakespeare Road to Battery Road intersection, then turn in a south westerly direction along Battery Road to meet with Hyderabad Road. Turn south into Hyderabad Road continuing around the base of Napier Hill until turning east into Carlyle Street and Emerson Street to Marine Parade.

The scheme includes houses on both sides of all roads, apart from Battery Road which includes the south side only (even numbers) and Hyderabad Rd which includes only the eastern side.

Contact Us

The school office is open from 8.30am to 3.30pm each school day. Outside of these hours a telephone answering service is available.

CONTACT US VIA:

Telephone: 06 835 8136
Email: office@napiercentral.school.nz
App: iOS/android
Web: www.napiercentral.school.nz
Post: 32 Napier Terrace, Hospital Hill
Napier 4110

When the telephone answering service is on during the day, please choose from the following options:

Press 1 for absences.

Press 2 for assistance.

PHONING OUT OF HOURS

Press 1 to leave a message or absence.

Press 2 Press 808 for HASCAP.

At times we use students to answer the telephone. Please get them to repeat the message back to you to confirm they have taken it down correctly. This is important when you are leaving messages regarding collection arrangements for children.

School Map

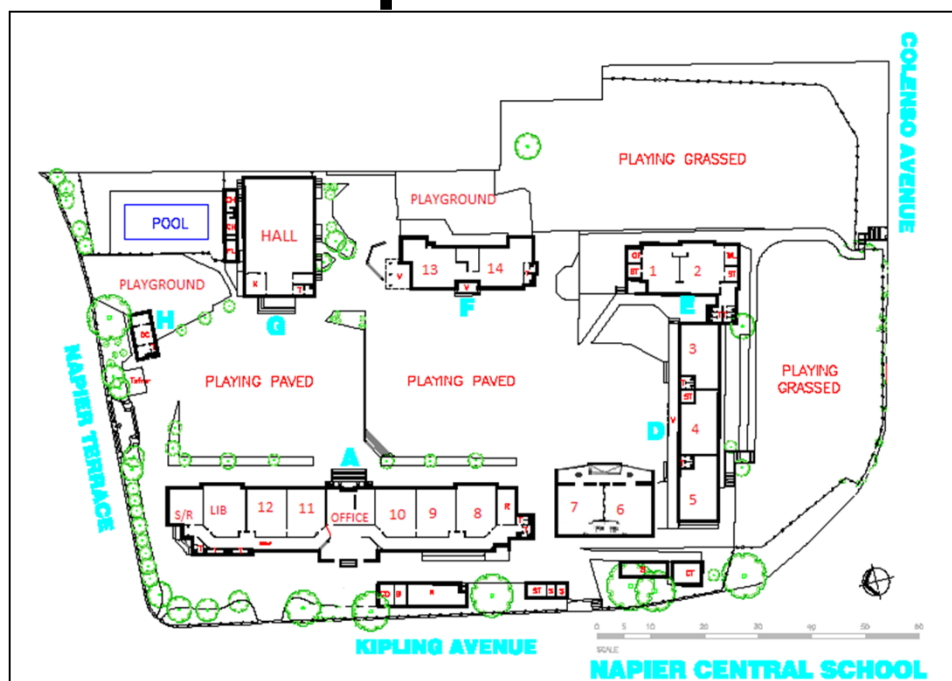

Our School Staff



Principal
Ross McLeod

Team Leaders



Jane Taylor Rm 13
Senior School



Carol Scott Rm 2
Junior School



Kirk Smith Rm 12
Middle School

Classroom Teachers

Helen Thomsen	Rm 1	Year NE/1
Carol Scott	Rm 2	Year 1
Lynne Floden	Rm 2	Year 1
Kylee Udy	Rm 3	Year 2
Anel van Tonder	Rm 4	Year 1 / 2
Eddie Schulberg	Rm 6	Year 5 / 6
Steve Drury	Rm 7	Year 5 / 6
Liz Perry	Rm 9	Year 3 / 4
Nerolee Devery	Rm 11	Year 3 / 4
Kirk Smith	Rm 12	Year 3 / 4
Jane Taylor	Rm 13	Year 5 / 6
Lisa Jones	Rm 13	Year 5 / 6
Heidi-Ann Phillips	Rm 14	Year 5 / 6

Office Administrators

Susie Pritchard
Tracy Roberts
Nat McKenzie
Caretaker
Glenn Thomson
Librarian
Megan McLean
Teacher Aides
Bronwyn Davies
Debbie Bradley
Jo Anderson
Megan McLean
Michelle Pittman
Rhonda Parsons
Rochelle Robinson
Liz Greene



Board of Trustees

CURRENT BOARD of TRUSTEES

Ingrid Squire (Chair)

Christian Pera

Mandy Ward

Daniel Kerr

Gabby Allen

Ross McLeod (Principal)

TBC (Staff Rep)

The Board of Trustees is charged with governing our school. Their responsibilities include:

- supporting the management team in the leadership of the school
- ensuring children receive the best education opportunities
- reviewing the School Charter
- ratification of school policies
- personnel and industrial matters
- property management
- consulting with the community

They welcome comments from parents and offer a Community Survey every 2 years which you are encouraged to participate in.

Parents are welcome to attend all BOT meetings. Copies of the Minutes are available for reading in the school office. BOT meetings are usually held once a month at 5.30pm in the School Staffroom and dates are advertised in the School Newsletter.



SCHOOL DONATION

Although all schools are funded by the government there remains a significant shortfall between this amount and what is needed to run a school. Without your contribution, our school would not be able to make ends meet.

The amount of the school resource contribution is set by the Board of Trustees each year. Whilst it is acknowledged that this is a voluntary payment our school is very well supported and has received over 80% of school donations most years.

The school donation for 2024 is a flat fee of \$150 for each child with a cap of \$400 per family.

Payment can be made as a lump sum or through instalments during the year. The preferred payment method is through the Edge Caregiver Portal. Remember that these payments are tax deductible and receipts will be issued.

Enrolment of your child

CHECKLIST FOR ENROLING YOUR CHILD

Please provide the following documents:

- Birth Certificate or Passport
- Proof of Address
- Immunisation Certificate
- Custody Papers – if required
- Student Visa – if required

Please complete and bring in the following forms found in this enrolment pack:

- Pupil Enrolment Form
- In-Zone Agreement (not required if you are an out-of-zone enrolment)
- Emergency Collection
- Child Health Programme
- Trip Consent
- Internet/Media Permission / Refusal
- Asthma Action Plan – if required
- HBDHB Health Form

* In the case of any Custody Agreements, we are required to obtain a copy of any agreements or conditions relevant for your child.

* If you are not a resident of New Zealand and have recently arrived in the country you will need to provide a copy of your passport and any relevant paperwork showing your Residents Permit or Student Visa.



School Entry Meetings for New Entrants

These are held on the second Thursday of a new term for parents of prospective New Entrant children. At this meeting parents will be introduced to the school along with an explanation of timetables, programmes, booklists, and the homework programme.

You can contact the school office to confirm the date of the next visit scheduled.

Future Focused Education

WHY PARENTS CHOOSE NAPIER CENTRAL SCHOOL

1. *Best Teaching Practice*

Teachers are committed to embracing best practice supported by the latest educational research. In recent years teacher professional development has strengthened knowledge and understanding in maths, literacy, cultural responsiveness, local history and play based learning.

2. *A balanced and focused curriculum*

We believe in being true to our school motto of 'lay well thy foundation' by developing active and empowered learners. The school places emphasis on providing a balanced curriculum, covering academic, cultural, and sporting arenas.

3. *Home and School – A Partnership*

The school places emphasis in developing a partnership between the school and home in the development of your child, recognising that it is through collaboration that we give children every opportunity to reach his or her potential.

4. *Learning Support*

Provided to children with learning difficulties in literacy and numeracy. The school also offers a Structured Literacy Approach at Years 1 & 2.

5. *Special Needs and Abilities*

The school actively supports and manages children identified with exceptional talents to ensure they are challenged, and their learning needs met.

6. *SunSmart*

We are an accredited SunSmart school having developed and implemented a sun protection policy for Terms 1 and 4 including the requirement for wearing broad brimmed sunhats during these terms. Being sun safe is a priority learning objective and an important factor in any outside event planning. Reapplication of approved sunscreen is reinforced throughout the school day.



7. Physical Environment

What other school offers such panoramic views of Hawke's Bay!



We take tremendous pride in the grounds and the school is maintained to a level that offers safety and is conducive to teaching, learning and fun. The Adventure Playgrounds are well used and well-liked by all ages.

8. Sports

The school supports a wide variety of team sports, including cricket, softball, basketball, volleyball, hockey, netball, football, rippa rugby and futsal. Also, through the year the whole school participates in swimming, tennis, athletics, cross country, and gymnastics. Optimist yachting is enjoyed by the Year 6 students at the end of every year.

9. Cultural, Choir and Orchestra

We have a strong school choir, enthusiastic Kapa Haka group and well-resourced orchestra giving students plenty of opportunity to create, perform and listen to a wide variety of musical genres.

Every second year we produce a dramatic/musical production staged at a local theatre. The 2021 production of Peter Pan was postponed due to covid but may be put on this year.

10. Digital Technology

Napier Central School recognizes the need for computer literacy which starts from day one. We offer Year 5/6 students the opportunity to bring their own device to school enabling them to be fully involved in using these devices in different aspects of their school work. Chrome books and i-pads are used throughout the school to support learning and teaching programmes.



Years 1 to 6 are your child's most formative years and we firmly believe between Napier Central School's balanced curriculum and the partnership we nurture between the home and school, we are well poised to 'lay well thy foundation' for your child and ensure they realise their individual potential.

Enviro-schools Programme

Napier Central is proud to be a part of The Enviro-schools Programme which focuses on environmental learning and action. We have implemented a number of projects with a sustainability objective encouraging and supporting our children to act for real change.

Garden to Table

Our Garden to Table programme started in 2021 and we join over 200 other schools around Aotearoa. Garden To Table is New Zealand's leading food education programme and links beautifully with our school curriculum and our goals as an Enviro-School.

The programme empowers our students for life through highly practical, hands-on classes. It also builds awareness of individual and collective responsibility for the environment, healthy eating, and community connectedness.

We provide opportunities for children to get their hands into the earth and learn how to grow, harvest, prepare and share fresh, seasonal food.

Students spend time in our productive veggie garden and in the school kitchen learning skills that will last them a lifetime. Children are encouraged to take that learning back to their family and community by sharing produce and recipes they have tried at school.



Culture and the Arts

SCHOOL MUSICALS

Our school holds a proud tradition of producing a polished musical production, delivered in a 'real theatre' environment for the students to experience the thrill of performing on a live stage. Productions to date have been tremendously successful, thanks to the many voluntary hours given by staff and parents, either through direct involvement or through assisting with costuming, props, and scenery.

CHOIR

We have a school choir which meets regularly during the school year to practice songs to present at assemblies and at special events.

ORCHESTRA

We have a strong school orchestra which meets regularly during the school year to practice songs to present at assemblies and at special events. Tuition in individual instruments is held on Friday mornings and full orchestra practice is at lunchtime.

The choir and orchestra visit kindergartens each year to perform to the children.



KAPA HAKA

We have an enthusiastic Kapa Haka group (year 2 up) which meets weekly during the school year to practice Waiata and Haka, which they perform at Assemblies, Festivals and Special Occasions. We regularly participate in the Ngati Kahunguna Kapa Haka Festival.



MUSIC LESSONS

For children aged 7+ we have itinerant teachers of guitar and drum who provide individual or small group lessons during school time. The cost of this is met by individual parents.

For Your Information

SCHOOL HOURS

Road patrols commence at 8.20am. Parents, please remember that you are responsible for your children until this time.

Children are encouraged to arrive at school 15 minutes before class instruction begins at 8.50am.

Once children have arrived at school for the day, they must not leave the school grounds without the parent/caregiver signing them out at the school office. If children arrive after school starts please sign them in at the office.

8.20am	Children may enter the school grounds & sit on benches.
8.30am	Children may enter the school buildings.
8.50am	Classroom instruction begins.
10.50am	Read / Feed Break
11.00 – 11.20am	Morning interval.
12.45 – 1.45pm	Lunch interval.
3.00pm	End of school day. Children are to be collected promptly.
3.20pm	School grounds should be cleared. Any children not under adult supervision by this bell, need to go to the office.

- * School hours are not altered for wet days.
- * School hours may be shortened for teacher parent interviews however this is communicated to parents in advance.

TERM DATES - 2024

Term 1 Wednesday 31 January – Friday 12 April

Term 2 Monday 29 April - Friday 5 July

Term 3 Monday 22 July - Friday 27 September

Term 4 Monday 14 October – Friday 20 December (TBC)



EMERGENCY PROCEDURES

In the event of fire, earthquake, or lockdown during school hours the school has clear policies and procedures with practises held each term. Evacuation plans are displayed in all classrooms and major areas. If you are a visitor to our school, please observe the evacuation procedures should the bells ring whilst you are on site. Do not re-enter buildings until given the instruction from the principal.

In the case of a major emergency, students will only be released to their parents or those nominated on our school Emergency Collection form which is completed as part of the enrolment procedure.

SEVERE ALLERGY AWARENESS

Napier Central School has a small number of students with peanut / nut allergies. For some of these students, their allergic reaction to peanuts and nuts is produced by mere smell or residue left by a student who has eaten food with nuts and/or peanuts. An allergic reaction for a student with anaphylaxis can be life threatening and in many cases the reaction is very swift in onset. Staff have been trained to respond if there was an emergency.

As an allergy aware school, we do allow children to bring nuts and food containing nuts in their lunch, but we ask if you could help your child understand the importance of safe food practices. We appreciate your understanding and thoughtfulness in this matter.

CLASS TRIPS

Educational trips and visits enhance learning by providing opportunities for students to gain knowledge and experience away from the classroom. We ask that you complete a Trip Consent form as part of the enrolment procedure. The school completes a Risk Assessment Management form to ensure the safety of all participants.

Parents will be informed of all class trips, and some may ask for parent support. If private vehicles are to be used, they will be required to have a current warrant of fitness and registration. Seatbelts must be provided for all children and drivers will need to have the appropriate drivers' licence. Children under seven years will be required to have a booster seat to travel in cars.

ROAD PATROL AND PARKING

Being a school on a hill parking is at a premium. We request in this regard that you choose safety over convenience.

- Road Patrol operates on Kipling Ave from 8.20 - 8.50am and 3.00 – 3.20pm and is supervised by a roster of parents.
- Please encourage your child to use the patrol-controlled crossings while it is operating.
- Please park well clear of the crossing area.
- Please **do not** park over driveways, yellow lines, or clear ways.
- There is **no** parking available on school grounds.

PARENTAL ASSISTANCE

We welcome and encourage the support we receive from parents and friends. Some ways that you could offer your help are:

- Supervising road patrol.
- Classroom and teacher help.
- Sports coaching or management.
- Supervision on trips/camp.

LUNCH ONLINE

Lunch Online is an online lunch ordering service and available Tuesday through Friday with a varied menu. Open an account with lunch online and the purchased food will be delivered to the school in time for lunch. See online for full menus.



SCHOOL STATIONERY

Class stationery packs are available for purchase from HB Office Products at 44 Wakefield Street, Onekawa before the start of Term One so children can be ready to start learning from day one. The office staff and teachers work together to provide good quality stationery at competitive prices.

Any stationery required throughout the year can be purchased from the school office daily 8.30 to 8.50am.



Edge Caregiver Portal - Online Payment Facility

The Edge Caregiver Portal allows you to view school information about your child(ren), and to make school expenses online. The portal gives you quick and easy access to the information for students in your household.

This is now our preferred method for making any school payments.

To Login - for the first time

Enter in your email address and click "forgot password". The Edge will then send you a password via that email.

Please Note: The Portal uses the email address that you have given us and is loaded into our system. If you do change your email address, please let the office know.

There are two methods of payment to choose from on The Edge:

- POLi allows you to pay amounts securely by Internet Banking.
- Paystation allows you to pay amounts securely by credit card.

SCHOOL BANKING

It is never too early for your child to learn about money and saving. ASB is working with our school to make it easy and fun as well. You can register your child for school banking by requesting a form from the school office. Once a child has opened their ASB Headstart account they can bank some of their pocket money every week at school placing it into the ASB box in the office foyer.

PAYMENT OF SCHOOL RELATED COSTS

We are a **cashless** school so the preferred payment method for such things as school trips, sports, school events etc, is through the Edge Caregiver Portal.

More information on how to set yourself up on this is available at the office.

We also offer eftpos options.

LOST PROPERTY

We do not take responsibility for the loss of children's belongings at school, but we do take appropriate measures to minimise the problem. All clearly named clothing and other personal property can be returned to the owner easily so please help us by making sure all items are named.

Lost property is kept in the hall and is displayed on the hall steps from time to time during a term. At the end of the year all unnamed and unclaimed property will be disposed of.

SWIMMING POOL

The school pool is used by all classes during the summer months.

Pool keys may be hired from the office for families of the school to use the pool outside of school hours over the summer. The BOT does set rules and conditions associated with such use of the pool.

CONCERNS & COMPLAINTS

If you have a concern regarding your child's progress or school life, please discuss the matter in the first instance with the class teacher. The syndicate leader is also available to assist in dealing with concerns.

If you still have concerns after these steps, we are happy for you to make an appointment to discuss the matter with the Principal. Contact the school office for an appointment time unless the issue is an urgent health or safety matter.

If you are still not satisfied after taking up the issue with the Principal, follow up with a letter to the BOT chairperson. The BOT will work to mediate a successful outcome. Our goal is to gain a positive working relationship and endeavour to deal with any issues in a timely fashion.



Helping You Stay Informed

SCHOOL WEBSITE

Keeping up to date with what is going on in and around the school is easy through our website. www.napiercentral.school.nz.

- Keep current with the school community calendar.
- View the latest school newsletter and notices.
- A great place to access photos of school life and learning.
- Access the latest school surveys.

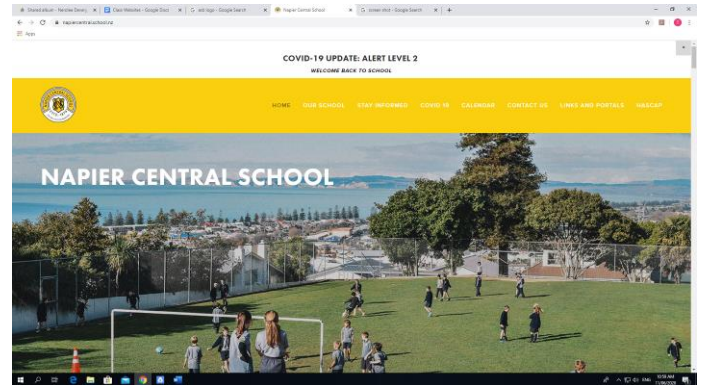

SCHOOL NEWSLETTERS - Sign up to this on the school website!

The fortnightly newsletter is our most important communication link as it keeps families informed about upcoming events, children's successes, and any concerns. It is important to check out every issue.

Log onto our school website and register to receive an electronic copy, emailed every second Monday. You can also download a copy from the App.

We still print a few copies that will be held at the school office should you need a hard copy.

There are also individual notices for sports, class trips and events occurring in the school that will either be emailed or sent home with the children.

Newsletters and notice can also be download from the **school website** or app.



SCHOOL APP

Download the App to your phone or tablet. Absentee notices can be sent into the office through this App and you can sign up for Alerts and receive timely reminders.

SCHOOL ASSEMBLIES

Student lead assemblies are held in the school hall fortnightly on a Monday afternoon starting at 2.15pm. Please check the school newsletter and community calendar for any changes to the normal programme. Parents are welcome to come along and celebrate student achievements at the assemblies.

Personalise Your App Experience

The Napier Central School App is available free for both Apple and Android devices. Simply go to the App Store or Google Play store and search for **SchoolApps NZ**.



App Features

- Parent notifications
 - Important website links
 - Click to call/email absentee
 - List of important School contacts
 - Maps
 - Term Dates
 - Website Newsletter
- Website Notices
 - Sports links

How to download the SchoolAppsNZ App to your mobile device

- Go to the App Store or Google Play store on your mobile device
- Search SchoolAppsNZ
- Download, then open the App
- When it asks to send notifications – click allow
- When it asks to search your School – type your School Name in the search Bar.
- Lastly, subscribe to the Alert Groups you would like to receive alerts for
- You are now all set.

SUBSCRIBE TO ALERT GROUPS

The Alerts Module allows you to subscribe to specific School Alert Groups so that you can receive alerts relevant to you and your child.

Absences and Illness

IF YOUR CHILD IS UNWELL AT SCHOOL /ADMINISTERING OF MEDICATIONS

If a child is deemed unwell or is a victim of a serious accident, the parent/caregiver is contacted. If no responsible person can be contacted, the Principal or Associate Principals will take whatever action is deemed necessary in the interest of the pupil.

Personal medication, suitably labelled need to be held in the Medical Room (i.e. asthma inhaler). Essential or emergency medication can be administered at school, but forms need to be completed in the school office, with clear instructions before medicines can be administered. All students with asthma must have a completed Asthma Action Plan.

Parents are encouraged to administer all other medicines at home. No medication will be administered unless parents have completed the appropriate instruction documents.

ATTENDANCES AND ABSENCES

Irregular attendance is a major cause of learning difficulty. Home and school must work together to ensure that each child attends school as often as possible. Attendance requirements permit absence only if a child is ill. Children may not be kept away for any other reason.

Unexplained absences are followed up in the interest of child safety.

Ways to report absences: School answer phone - 835 8136 option 1
 School App
 School Office

As the office email is not always checked before absences are done, emailing absences is not as reliable as using the School App.

If your child is sick, please do not send them to school. 24 hours clear after vomiting and 48 hours clear after diarrhoea.

If you are taking your child out of school for any reason, or if they are late for school, please sign the register at the Office.

If families are going to be away from school for a period of 2 weeks or more, a written letter to the school office is required. Please discuss with the classroom teacher possible work during the absence.

LATENESS

Being on time for school is important as it has a positive impact on learning. While we appreciate that unforeseen things can come up, lateness should not become a regular occurrence.

School Uniform

The wearing of the school uniform is a condition of enrolment at Napier Central School.

We hold enough stock at the school for all new enrolments and recommend that you have your child come in and try it on for sizing. A volunteer parent is available to assist with this on Friday mornings from 8:20am - 8:50am. A small second-hand uniform market is available during this time as well. If you require additional uniform after your initial purchase, you can order this from academyapparel.co.nz. The SHOP link in is the top right-hand corner.

We also offer the opportunity to order through the school office when we submit a bulk order every term allowing you to save on postage costs. Check the school newsletter for the dates.

Please remember to name all clothing.

Financial options are available to help spread the cost of paying for the uniform on a 'lay-by' basis or an application for financial hardship can be submitted to the Principal. Where genuine hardship is deemed to exist, the school will come to an arrangement that allows the pupil access to the school uniform.

SCHOOL HATS

Approved sun safe broad brimmed sunhat are compulsory items of your child school uniform during Terms 1 and 4. These are kept in stock at the school office.

ACCESSORIES GUIDELINES

- Dark shoes or sandals (with strap across)
- Thermal Undergarments - Navy
- Tights - Dark Navy tights
- Socks – Navy/Black
- Hair that is touching or beyond the collar should be tied up, off the face. Any fringe that grows in front of the eyes, past the eyebrows, should be clipped back.
- Headbands - navy blue, white or yellow
- Jewellery
 - stud earrings
 - watches
 - Medic Alert bracelet
 - an item of family, cultural or religious significance - (after consultation with the principal)

No other jewellery is permitted.



School Sports

Napier Central School has a sound sporting reputation and offers a wide variety of sporting activities and challenges.

We also need support for coaching the sport teams. If you are to assist with coaching in one of the codes please see Jane Taylor, Associate Principal.

Summer sporting codes include:

Swimming sports in early March
Cricket Terms 1 and 4
Basketball
Volleyball
Futsal
Tabloid Sports
Athletics
Triathlons

Winter sporting codes include:

Netball
Hockey
Rugby
Barefoot 7s
Cross Country
Interschool Cross Country
Football

Many of our students also play for local teams under the Club systems for football and rugby. Please make enquiries at local clubs if your child is interested in these sports.

Travel to and from the games is the responsibility of the parents.



School Camp

Each year students from Year 5 and 6 attend school camp during a suitable school term. This year camp dates are between 18 – 22 March.

There are plenty of activities at the school camp to challenge the students and the students thoroughly enjoy the experience.

Parents of students attending camp are invited to make application each year to attend the camp as camp parents to assist the teachers with supervision.

Camp meetings for parents are held approximately two weeks before students go off to camp to give parents the opportunity to have any questions/concerns addressed.

If you would like to find out more about the school camp please see your child's classroom teacher or the Associate Principal of the Senior Syndicate; Jane Taylor.



Parent Teacher Association (P.T.A.)

Napier Central School has an active PTA and would like to use this opportunity to encourage you to join. The PTA brings parents and teachers together to successfully raise funds which is used for the benefit of our children.

In the past the money we have raised has gone for E-learning - chrome books and iPads; landscaping across the school; sports shirts; Kapa haka uniforms; school pool revamp; sunscreen for the whole school and decorations for the Year 6 dance to name a few.

Some of the fundraising ideas that have been PTA run are school discos, sausage sizzle, cake stall, summer ice block sales, calendars, quiz and movie nights. During 2018 our big fundraising project was the community cookbook—Neighbourhood Eats. We are always open to new ideas from the school community.

Meetings are held on the 2nd & 8th Monday of every term at 6.30pm in the school staffroom (see website for the dates of each meeting). All parents and friends of the school are welcome to attend. This is a great way of sharing in the school community.

PTA BANKING DETAILS

For any PTA fundraising projects, money going to them should be deposited into the PTA account:

ASB 12 3144 0223493 00

PTA FRIDAY SAUSAGE SIZZLE

A very popular lunch option on Friday as children can get themselves a sausage or two for lunch. These are \$2.00 each for sausage in bread. Sausages can be ordered through Lunchonline and children are able to pick up their sausage at lunchtime from the lunch area. We welcome parents to volunteer to be a Sausage Sizzler and share in the smiles on the children's faces.

PTA INFORMATION

Keep up with current events through the school app and newsletter.

HASCAP

Hill After School Care and Play

Providing safe and organised care for children before and after school while keeping the important element of fun



The facility is currently operating from Room 8 under the management of Tracy Roberts.

Contact Phone 021 109 3884
troberts@napiercentral.school.nz
or leave a message at the school office.

Mission Statement

The object of the Trust is to provide quality care for children who attend HASCAP. To ensure that HASCAP runs smoothly and continues as a financially viable enterprise. To offer support to the staff employed by HASCAP. The Trust can be contacted through the school office. To contact HASCAP when the school office is closed please ring 835 8136 ext 808.

Operating Hours: 7.30-8.30am, 3.00-5.30pm term time.

Holiday programmes are from the first week of a two-week holiday and a total of three weeks during the December/January holidays.

Fees Structure

\$6.50 per hour 1 child

\$6.00 per child per hour 2 + children

There is a minimum one-hour charge in the afternoons. Forms for WINZ subsidies can be obtained from the supervisors.

For more information, please see the school website.

<https://www.napiercentral.school.nz/hascap>



Enrolling and booking online at hascap.aimyplus.com



Reporting to Parents

MIDDLE AND SENIOR SCHOOL –

FEBRUARY - A Meet the Teacher afternoon is held each year in February to give parents an opportunity to meet teachers and discuss class routines.

MARCH MEETING WITH PARENTS - 10-minute interviews with teachers to discuss goals and progress of your child.

JUNE THREE WAY CONFERENCES - These are usually held on two days with the school closing early to allow enough time to allocate an interview time per family. Conferences are usually 15 minutes long and are between teacher, parent and student.

DECEMBER REPORTS - Written reports on the year's achievements are produced in December and sent out to all families.

This is subject to change due to constantly changing Covid settings and contact restrictions. Notice via the newsletter and teacher / parent emails will be sent out as necessary.

PARENT CONCERNS

Parents are encouraged to communicate first with teachers if problems arise. Early intervention is always best. Teachers are available for short meetings with parents during the school year. Please make the arrangement with the teacher concerned.

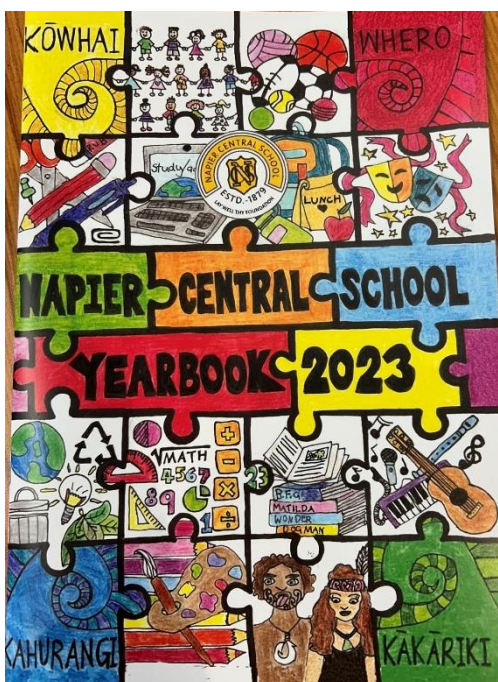

Frequently asked questions

▪ What is the school roll?

We generally start a year around with 250 children and close the year at approximately 280 children.

▪ What are the strengths of the school?

Our strengths echo our motto 'Lay Well Thy Foundation'. Strong teaching of the core subjects, along with supporting such things as thinking, creating, e-learning, inquiry and student collaborating agency, the Arts and sports. We are a very good all-round school and aim to give your child the best possible start to school.

ERO reports are another avenue for parents to read about the strengths of the school. These can be viewed at www.ero.govt.nz

▪ How do you use digital devices in the school?

We have a balanced approach to support and enhance learning and teaching.

▪ When can my child have a school visit?

Depending on the year level of the student a visit can be arranged at the time of enrolment. For New Entrant enrolments we suggest that parents book a time to visit the classroom with their child. Visits are available on Tuesday and Friday mornings and can be booked through the school office. Parents need to stay with the child throughout the visit.

If you envisage that your child will have difficulty settling in, an extra visit can be beneficial. This can be discussed with the classroom teacher.

▪ How do you determine class sizes and levels?

Class levels vary each year and impact on the makeup of class sizes. The aim of the school is to provide the best scenario to fit the levels required for the year considering the needs of students. It must be remembered that students enrol right through the year, so whilst an attempt will be made to keep class numbers as low as possible, midyear enrolments during the year can change this.

▪ How do you communicate with parents?

- A fortnightly newsletter - along with syndicate newsletters and class notices.
- Fortnightly assemblies for all to come along.
- The school App, website and Facebook page.
- A Meet the Teacher evening in Term 1.
- Parent/Teacher interviews during the year.
- Written reports are given to parents in December.
- BOT meetings and PTA meetings held regularly throughout the year.

Term dates, newsletters, notices, classwork, photos of the school in action can be seen on our website: www.napiercentral.school.nz. Important notices are sent out to mobile phones via the school App.

We look forward to your child joining our school.

Parent notes/questions

